

# ALL STEEL CARPORTS

www.allsteelcarports.com

Affordable Buildings, Exceptional Quality!

Local Dealer  
Phone Number \_\_\_\_\_

Any Size Carport,  
Garage, Storage Building  
& Motor Home Cover!  
CUSTOM SIZES AVAILABLE!

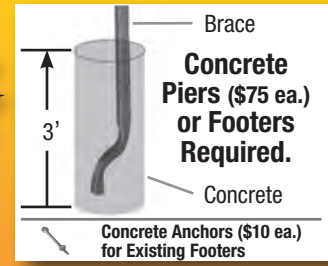

Before You Buy Anywhere Else, Compare  
Our Installation Schedules and Value-Added  
Standard Features!

Structural  
Engineer Designed  
For Added  
Strength

PLEASE NOTE:

Customer will be required to provide  
a telescopic lift during installation.



We also have a wide selection of  
12'-30' wide economy buildings.

A-Frame Vertical Roof with 8 ft. legs standard without side sheet metal

Pricing Includes Roof Only

<b>STANDARD 14 GAUGE VERTICAL 2 1/2" STEEL</b>	32 x 21	34 x 21	36 x 21	38 x 21	40 x 21	42 x 21	44 x 21	46 x 21	48 x 21	50 x 21
	\$5,195	\$5,595	\$5,995	\$6,395	\$6,795	\$7,195	\$7,595	\$7,995	\$8,395	\$8,795
	32 x 26	34 x 26	36 x 26	38 x 26	40 x 26	42 x 26	44 x 26	46 x 26	48 x 26	50 x 26
	\$6,495	\$6,995	\$7,495	\$7,995	\$8,495	\$8,995	\$9,495	\$9,995	\$10,495	\$10,995
	32 x 31	34 x 31	36 x 31	38 x 31	40 x 31	42 x 31	44 x 31	46 x 31	48 x 31	50 x 31
	\$7,795	\$8,395	\$8,995	\$9,595	\$10,195	\$10,795	\$11,395	\$11,995	\$12,595	\$13,195
	32 x 36	34 x 36	36 x 36	38 x 36	40 x 36	42 x 36	44 x 36	46 x 36	48 x 36	50 x 36
	\$9,095	\$9,765	\$10,495	\$11,195	\$11,895	\$12,595	\$13,295	\$13,995	\$14,695	\$15,395
	32 x 41	34 x 41	36 x 41	38 x 41	40 x 41	42 x 41	44 x 41	46 x 41	48 x 41	50 x 41
	\$10,395	\$11,195	\$11,995	\$12,795	\$13,595	\$14,395	\$15,195	\$15,995	\$16,795	\$17,595
32 x 46	34 x 46	36 x 46	38 x 46	40 x 46	42 x 46	44 x 46	46 x 46	48 x 46	50 x 46	
\$11,695	\$12,595	\$13,495	\$14,395	\$15,295	\$16,195	\$17,095	\$17,995	\$18,895	\$19,795	
32 x 51	34 x 51	36 x 51	38 x 51	40 x 51	42 x 51	44 x 51	46 x 51	48 x 51	50 x 51	
\$12,995	\$13,995	\$14,995	\$15,995	\$16,995	\$17,995	\$18,995	\$19,995	\$20,995	\$21,995	
32 x 56	34 x 56	36 x 56	38 x 56	40 x 56	42 x 56	44 x 56	46 x 56	48 x 56	50 x 56	
\$14,295	\$15,395	\$16,495	\$17,595	\$18,695	\$19,795	\$20,895	\$21,995	\$23,095	\$24,195	
32 x 61	34 x 61	36 x 61	38 x 61	40 x 61	42 x 61	44 x 61	46 x 61	48 x 61	50 x 61	
\$15,595	\$16,795	\$17,995	\$19,195	\$20,395	\$21,595	\$22,795	\$23,995	\$25,195	\$26,395	

NOTE: Frames are 1 foot shorter than roof length-wise

<b>PREMIUM 12 GAUGE VERTICAL 2 1/4" STEEL</b>	32 x 21	34 x 21	36 x 21	38 x 21	40 x 21	42 x 21	44 x 21	46 x 21	48 x 21	50 x 21
	\$5,595	\$5,995	\$6,445	\$6,845	\$7,245	\$7,695	\$8,095	\$8,495	\$8,895	\$9,295
	32 x 26	34 x 26	36 x 26	38 x 26	40 x 26	42 x 26	44 x 26	46 x 26	48 x 26	50 x 26
	\$6,995	\$7,495	\$8,045	\$8,545	\$9,045	\$9,595	\$10,125	\$10,625	\$11,125	\$11,625
	32 x 31	34 x 31	36 x 31	38 x 31	40 x 31	42 x 31	44 x 31	46 x 31	48 x 31	50 x 31
	\$8,395	\$8,995	\$9,645	\$10,245	\$10,845	\$11,495	\$12,145	\$12,745	\$13,345	\$13,945
	32 x 36	34 x 36	36 x 36	38 x 36	40 x 36	42 x 36	44 x 36	46 x 36	48 x 36	50 x 36
	\$9,795	\$10,495	\$11,245	\$11,945	\$12,645	\$13,395	\$14,175	\$14,875	\$15,575	\$16,275
	32 x 41	34 x 41	36 x 41	38 x 41	40 x 41	42 x 41	44 x 41	46 x 41	48 x 41	50 x 41
	\$11,195	\$11,995	\$12,845	\$13,645	\$14,445	\$15,295	\$16,195	\$16,995	\$17,795	\$18,595
32 x 46	34 x 46	36 x 46	38 x 46	40 x 46	42 x 46	44 x 46	46 x 46	48 x 46	50 x 46	
\$12,595	\$13,495	\$14,445	\$15,345	\$16,245	\$17,195	\$18,225	\$19,125	\$20,025	\$20,925	
32 x 51	34 x 51	36 x 51	38 x 51	40 x 51	42 x 51	44 x 51	46 x 51	48 x 51	50 x 51	
\$13,995	\$14,995	\$16,045	\$17,045	\$18,045	\$19,095	\$20,245	\$21,245	\$22,245	\$23,245	
32 x 56	34 x 56	36 x 56	38 x 56	40 x 56	42 x 56	44 x 56	46 x 56	48 x 56	50 x 56	
\$15,395	\$16,495	\$17,645	\$18,745	\$19,845	\$20,995	\$22,275	\$23,375	\$24,475	\$25,575	
32 x 61	34 x 61	36 x 61	38 x 61	40 x 61	42 x 61	44 x 61	46 x 61	48 x 61	50 x 61	
\$16,795	\$17,995	\$19,245	\$20,445	\$21,645	\$22,895	\$24,295	\$25,495	\$26,695	\$27,895	

\*12 Gauge - 20 year limited warranty on rust through of the framing assuming normal care and maintenance on the 12 gauge only.



NOTE: Colors may vary slightly

AVAILABLE IN 13 COLORS!  
See Reverse Side For Useful Options



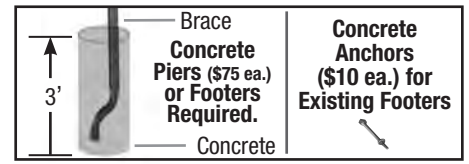

## Options and Accessories

BUILDING HEIGHTS	Leg Height	21' Length	26' Length	31' Length	36' Length	41' Length	46' Length	51' Length
	8 Feet	Std.	Std.	Std.	Std.	Std.	Std.	Std.
	9 Feet	\$190.00	\$235.00	\$280.00	\$325.00	\$370.00	\$415.00	\$460.00
	10 Feet	\$380.00	\$470.00	\$560.00	\$650.00	\$740.00	\$830.00	\$920.00
	11 Feet	\$570.00	\$705.00	\$840.00	\$975.00	\$1,110.00	\$1,245.00	\$1,380.00
	12 Feet	\$760.00	\$940.00	\$1,120.00	\$1,300.00	\$1,480.00	\$1,660.00	\$1,840.00
	13 Feet	\$950.00	\$1,175.00	\$1,400.00	\$1,625.00	\$1,850.00	\$2,075.00	\$2,300.00
	14 Feet	\$1,140.00	\$1,410.00	\$1,680.00	\$1,950.00	\$2,220.00	\$2,490.00	\$2,760.00
	15 Feet	\$1,330.00	\$1,645.00	\$1,960.00	\$2,275.00	\$2,590.00	\$2,905.00	\$3,220.00
	16 Feet	\$1,520.00	\$1,880.00	\$2,240.00	\$2,600.00	\$2,960.00	\$3,320.00	\$3,680.00
	17 Feet	\$1,710.00	\$2,115.00	\$2,520.00	\$2,925.00	\$3,330.00	\$3,735.00	\$4,140.00
	18 Feet	\$1,900.00	\$2,350.00	\$2,800.00	\$3,250.00	\$3,700.00	\$4,150.00	\$4,600.00

VERTICAL SIDES (both)	Leg Height	21' Length	26' Length	31' Length	36' Length	41' Length	46' Length	51' Length
	8 Feet	\$730.00	\$910.00	\$1,090.00	\$1,275.00	\$1,485.00	\$1,640.00	\$1,820.00
	9 Feet	\$790.00	\$995.00	\$1,210.00	\$1,440.00	\$1,690.00	\$1,785.00	\$1,990.00
	10 Feet	\$890.00	\$1,120.00	\$1,365.00	\$1,625.00	\$1,895.00	\$2,010.00	\$2,240.00
	11 Feet	\$995.00	\$1,245.00	\$1,520.00	\$1,805.00	\$2,105.00	\$2,240.00	\$2,490.00
	12 Feet	\$1,090.00	\$1,380.00	\$1,680.00	\$1,995.00	\$2,325.00	\$2,470.00	\$2,760.00
	13 Feet	\$1,195.00	\$1,495.00	\$1,795.00	\$2,095.00	\$2,395.00	\$2,695.00	\$2,995.00
	14 Feet	\$1,300.00	\$1,625.00	\$1,950.00	\$2,275.00	\$2,600.00	\$2,925.00	\$3,250.00
	15 Feet	\$1,400.00	\$1,750.00	\$2,100.00	\$2,450.00	\$2,800.00	\$3,150.00	\$3,500.00
	16 Feet	\$1,510.00	\$1,890.00	\$2,270.00	\$2,650.00	\$3,030.00	\$3,410.00	\$3,790.00
	17 Feet	\$1,620.00	\$2,025.00	\$2,430.00	\$2,835.00	\$3,240.00	\$3,645.00	\$4,050.00
	18 Feet	\$1,720.00	\$2,150.00	\$2,580.00	\$3,010.00	\$3,440.00	\$3,870.00	\$4,300.00

VERTICAL ENDS (per end)	Leg Height	32' Wide	34' Wide	36' Wide	38' Wide	40' Wide	42' Wide	44' Wide	46' Wide	48' Wide	50' Wide
	8 Feet	\$1,960.00	\$2,110.00	\$2,265.00	\$2,420.00	\$2,575.00	\$2,725.00	\$2,880.00	\$3,035.00	\$3,180.00	\$3,340.00
	9 Feet	\$2,190.00	\$2,455.00	\$2,400.00	\$2,550.00	\$2,800.00	\$2,860.00	\$3,015.00	\$3,165.00	\$3,320.00	\$3,475.00
	10 Feet	\$2,260.00	\$2,420.00	\$2,595.00	\$2,770.00	\$2,935.00	\$3,100.00	\$3,275.00	\$3,440.00	\$3,620.00	\$3,795.00
	11 Feet	\$2,430.00	\$2,585.00	\$2,740.00	\$2,890.00	\$3,045.00	\$3,200.00	\$3,355.00	\$3,510.00	\$3,665.00	\$3,815.00
	12 Feet	\$2,560.00	\$2,715.00	\$2,870.00	\$3,025.00	\$3,180.00	\$3,330.00	\$3,480.00	\$3,640.00	\$3,795.00	\$3,950.00
	13 Feet	\$2,715.00	\$2,880.00	\$3,035.00	\$3,180.00	\$3,340.00	\$3,450.00	\$3,650.00	\$3,805.00	\$3,950.00	\$4,115.00
	14 Feet	\$2,870.00	\$3,025.00	\$3,180.00	\$3,330.00	\$3,485.00	\$3,640.00	\$3,795.00	\$3,950.00	\$4,100.00	\$4,260.00
	15 Feet	\$3,025.00	\$3,165.00	\$3,320.00	\$3,485.00	\$3,630.00	\$3,780.00	\$3,935.00	\$4,090.00	\$4,255.00	\$4,400.00
	16 Feet	\$3,170.00	\$3,310.00	\$3,465.00	\$3,640.00	\$3,770.00	\$3,930.00	\$4,080.00	\$4,235.00	\$4,410.00	\$4,540.00
	17 Feet	\$3,330.00	\$3,454.00	\$3,600.00	\$3,795.00	\$3,915.00	\$4,070.00	\$4,225.00	\$4,375.00	\$4,565.00	\$4,685.00
	18 Feet	\$3,480.00	\$3,595.00	\$3,750.00	\$3,950.00	\$4,060.00	\$4,213.00	\$4,365.00	\$4,520.00	\$4,720.00	\$4,830.00

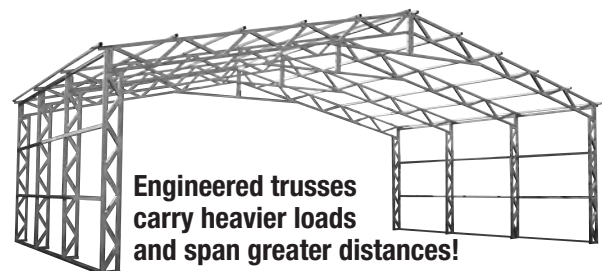

**Walk In Door**  
**32" X 72" \$225**  
 or  
**36" X 80" \$275**

**Windows**  
**30" X 30" \$175.00**  
**30" X 40" \$200.00**

**Garage Doors**

- White Only
- Garage door on side add \$200.00
- Leg height needs to be 2 ft. taller than door height

ROLL-UP COMMERCIAL GARAGE DOORS	Price
6' X 6'	\$350.00
8' X 7'	\$450.00
9' X 7'	\$500.00
10' X 8'	\$550.00
10' X 10'	\$600.00
10' X 12'	\$1,000.00
12' X 12'	\$1,200.00
12' X 14'	\$1,400.00

Prices are subject to change without notice!